

Installation Sheet for IP17 - Orb Rocker

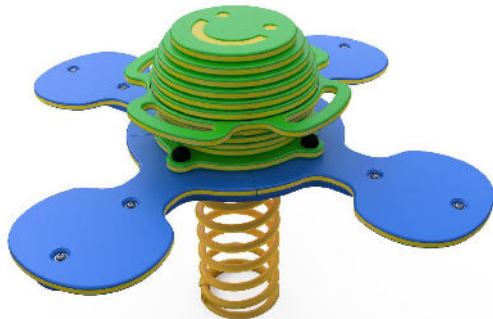

Product Name	Orb Rocker
Product Code	IP17
Document Release Date	31/08/2021
Document Rev	1
Total install Hours	4 Hours
Volume of Concrete Required	0.18m ³

EXPLODED VIEW - SPRING AND GROUD ANCHOR ASSEMBLY

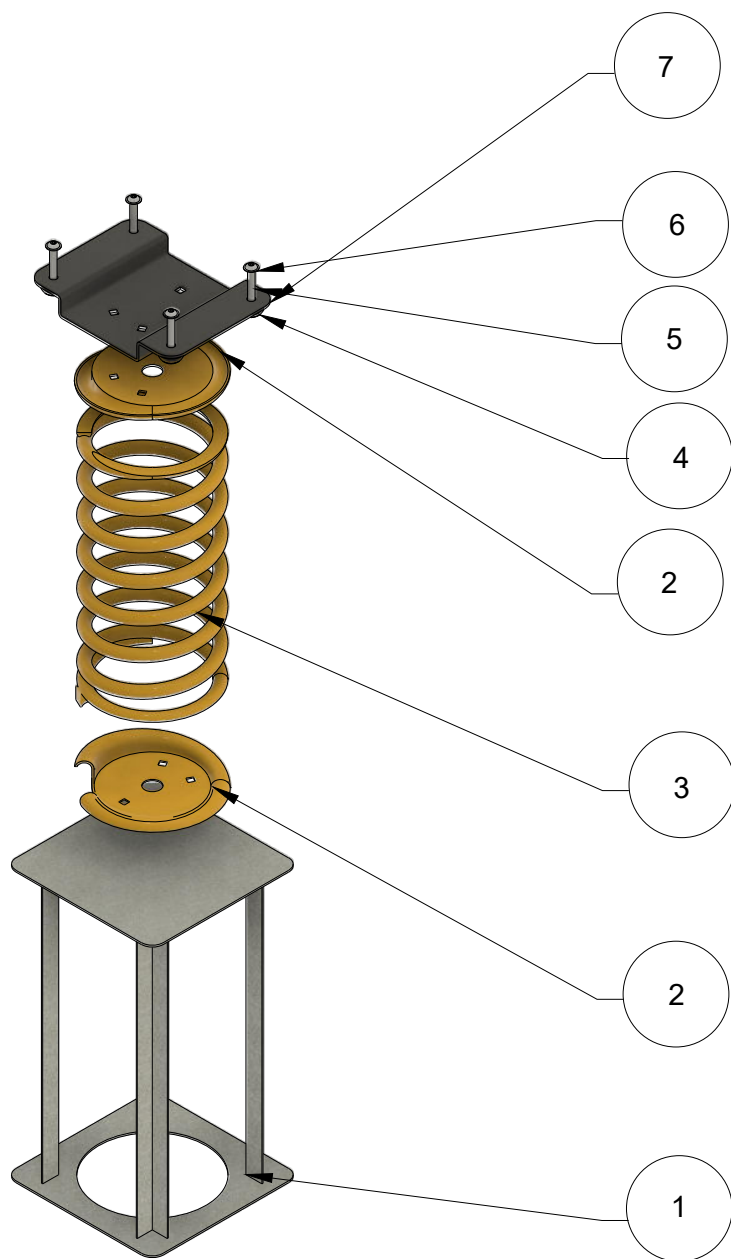

PARTS LIST			
ITEM NO	DESCRIPTION	PART NO	QTY
1	Ground Anchor	IP17 -GA	1
2	HD Spring Mounting Plate	FME0047 - A	2
3	HD 400mm ping (dia 200mm, Pitch 60mm, Bar 20mm)	FME0049 - A	1
4	M10 Dome Nut - SS	FSU0098 - A	4
5	M10 Plain Nut - SS	FSU0014 - A	4
6	M10 Locking Washer - SS	FSU0096 - A	4
7	Spring Rectangular Bracket	FME0041 - A	1



Installation Sheet for IP17 - Orb Rocker

INSTALLATION OVERVIEW



Two people are required for this installation.

Day One - 3 Hours

Excavate to 600mm x 600mm x 556mm.
See page 4. This is for the ground anchor support and cement

Place a slab or similar hard standing base into the bottom of the excavated hole.
Ensure this is level

Position ground anchors in place. See page 5. Ensure the ground anchors and springs are level.

Pour cement into the excavated hole, making sure that the inground support structure is fully immersed into the cement, leaving only the spring exposed. Do not cover any part of the spring in cement. A total of 0.18m³ is required of cement.

Leave cement to set.

Day Two - 1 Hour

When cement is set, place the product on top of the spring and bolt on securely. Ensure there are no sharp corners of the cement exposed. Ensure unit functions without breaking away from the installed foundations.

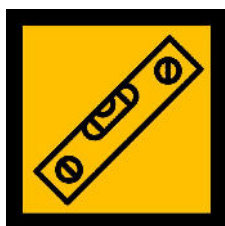

Check product is level and secure. See page 6

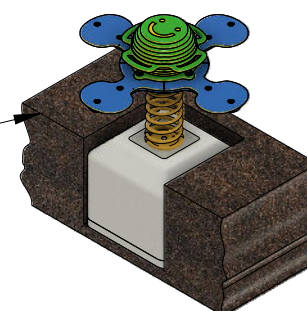
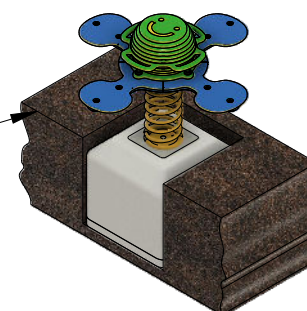
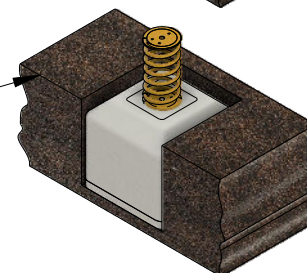
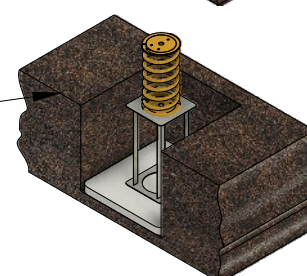

inclusive
play

3/8

Call us +44(0)131 214 1180

www.inclusiveplay.com

info@inclusiveplay.com

Installation Sheet for IP17 - Orb Rocker

Within the allocated space excavate 600mm x 600mm x 556mm.

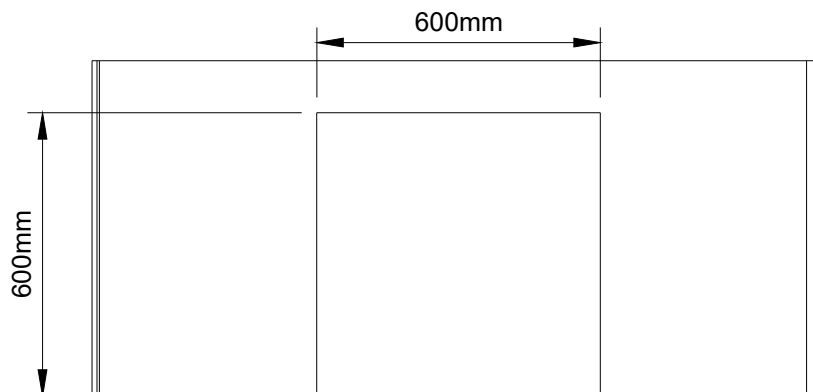
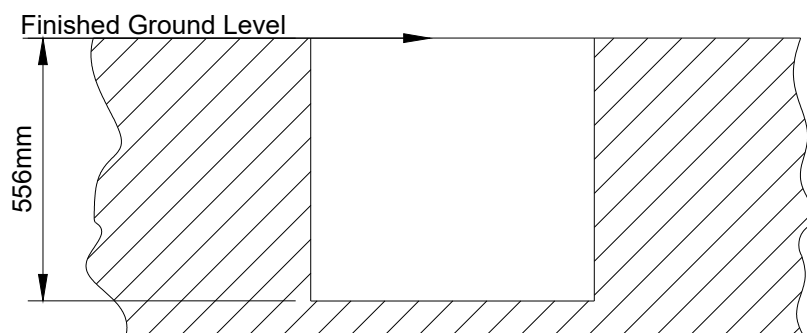

Place a slab or similar hard standing base into the bottom of the excavated cavity. Ensure this is level.

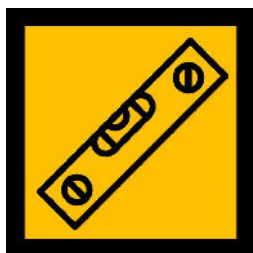

CHECK SPIRIT LEVEL

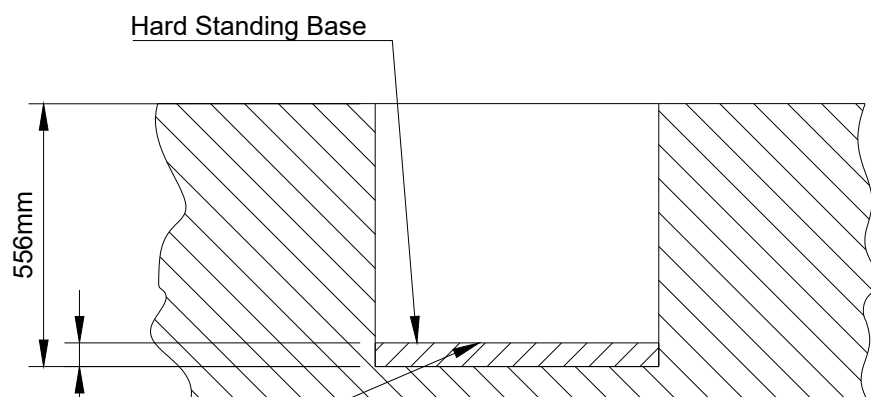

Hard Standing Base

Installation Sheet for IP17 - Orb Rocker

Before pouring cement check the levels of the ground anchors ensuring they are straight and level.

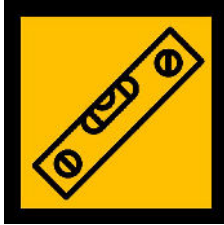

**CHECK SPIRIT
LEVEL**

Ensure cement
corners are rounded
off.

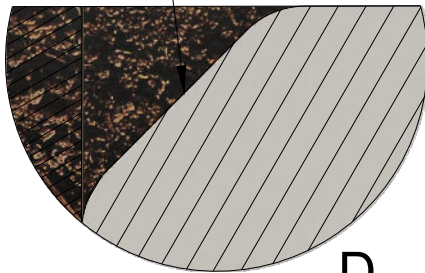

D

0.18 m³ cement volume required.

Fill to 500mm deep and check Ground
Anchors and Springs are level making
small adjustments where required
before the cement sets.

Ensure cement corners are rounded off.

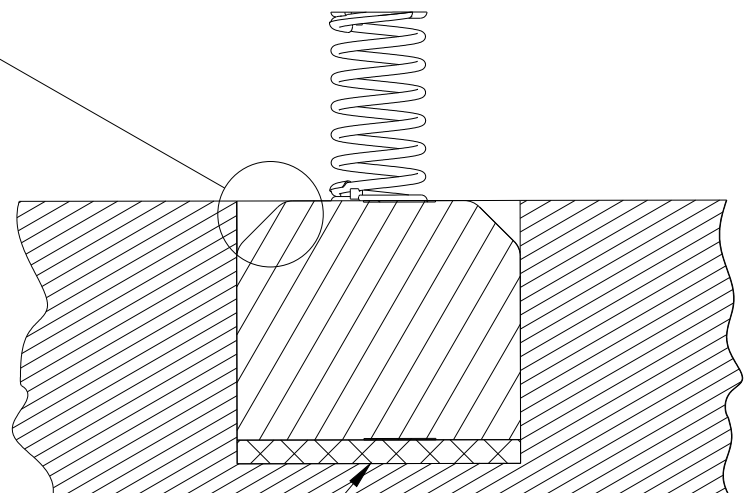
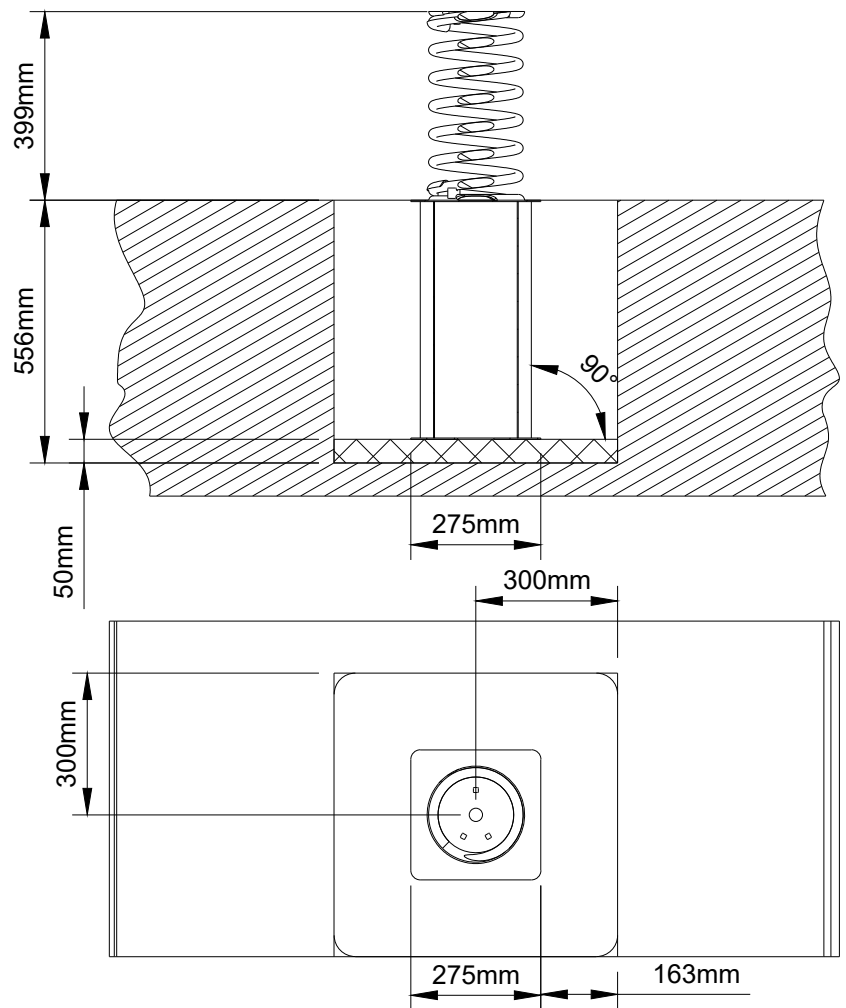

Hard Standing Base

Installation Sheet for IP17 - Orb Rocker

FOOTING DETAILS

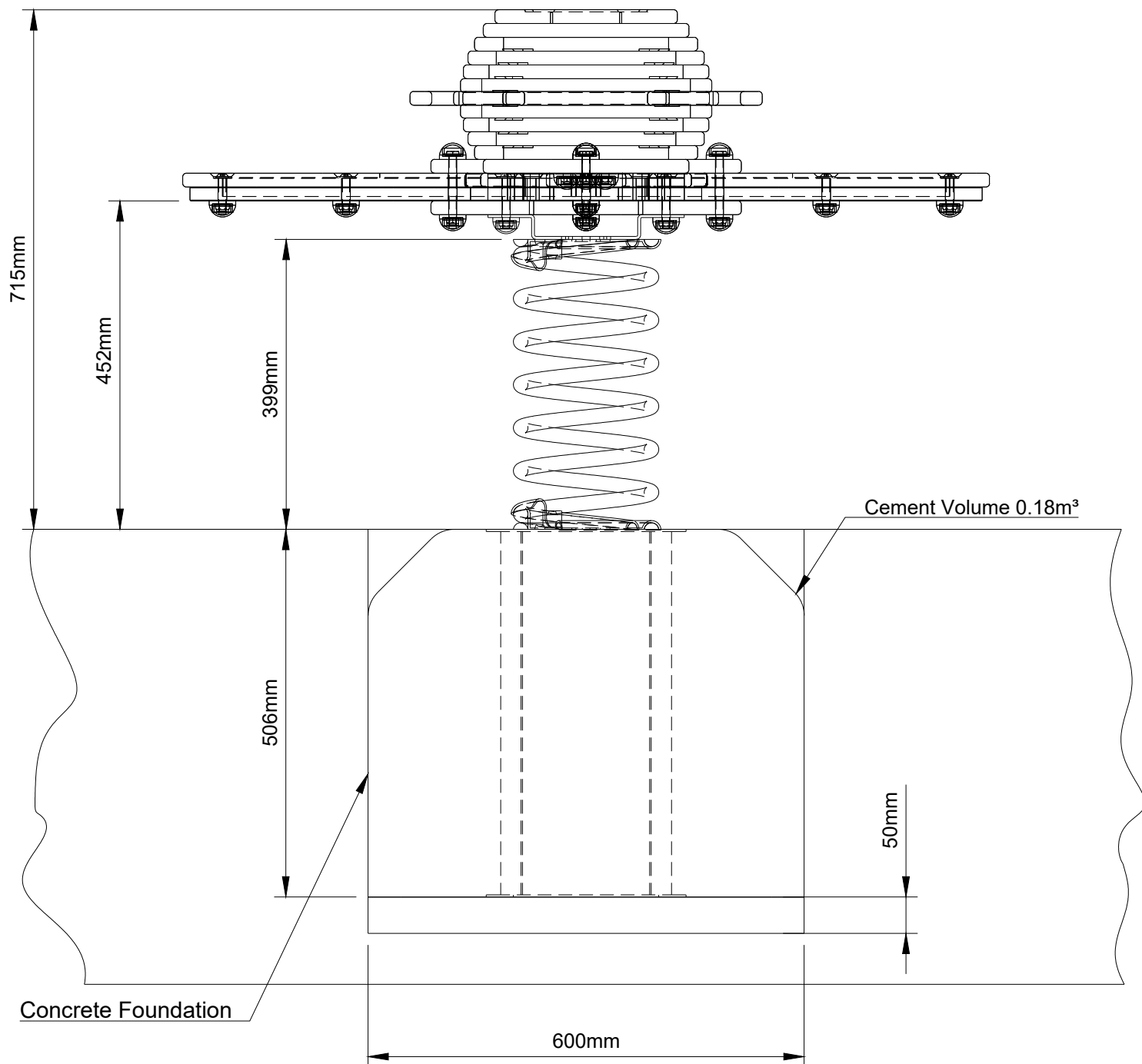

Installation Sheet for IP17 - Orb Rocker

Only when the cement is set and using the fixings provided, bolt the top Orb Rocker unit to the mounted Springs.

Ensure all fixings are tight and secure before making good the surface by packing down any gaps with the surface material



Check to ensure the installed unit is level.

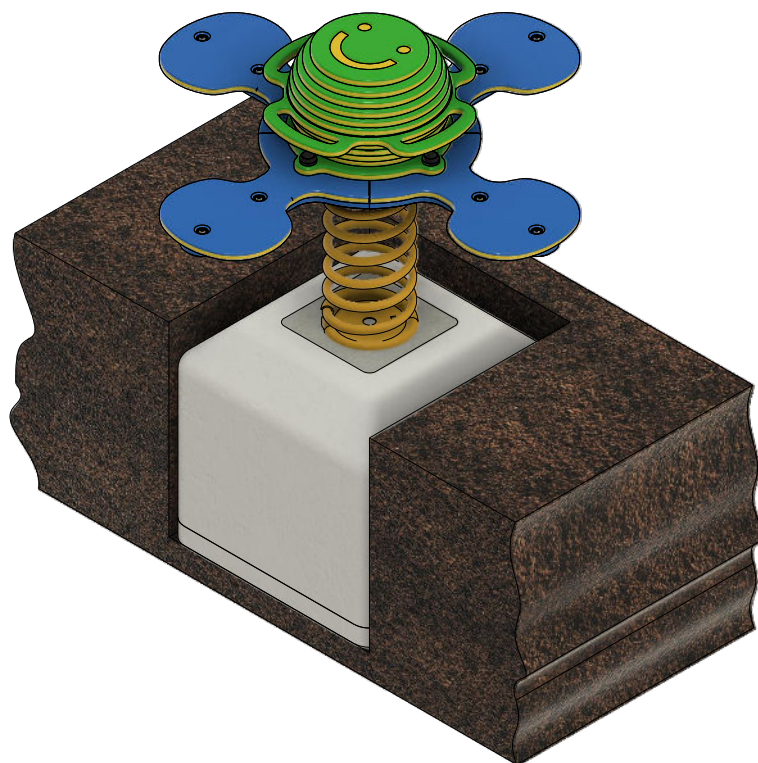
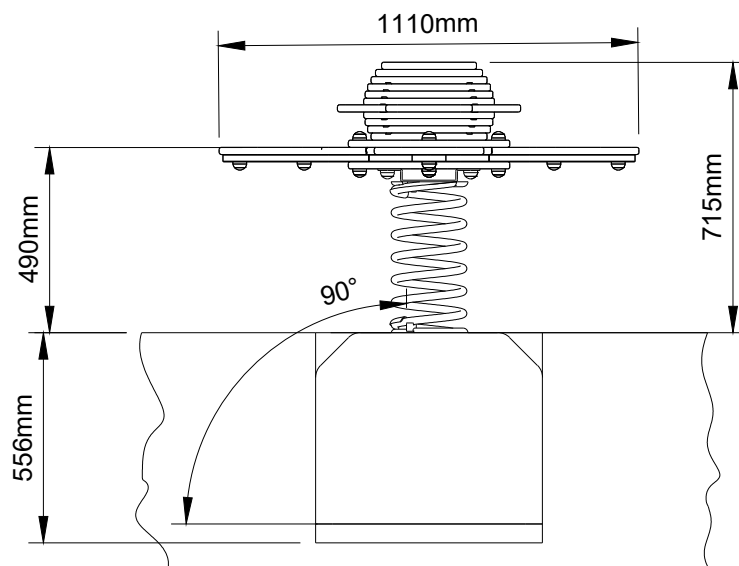

Installation Sheet for IP17 - Orb Rocker

SAFETY SURFACING DETAILS

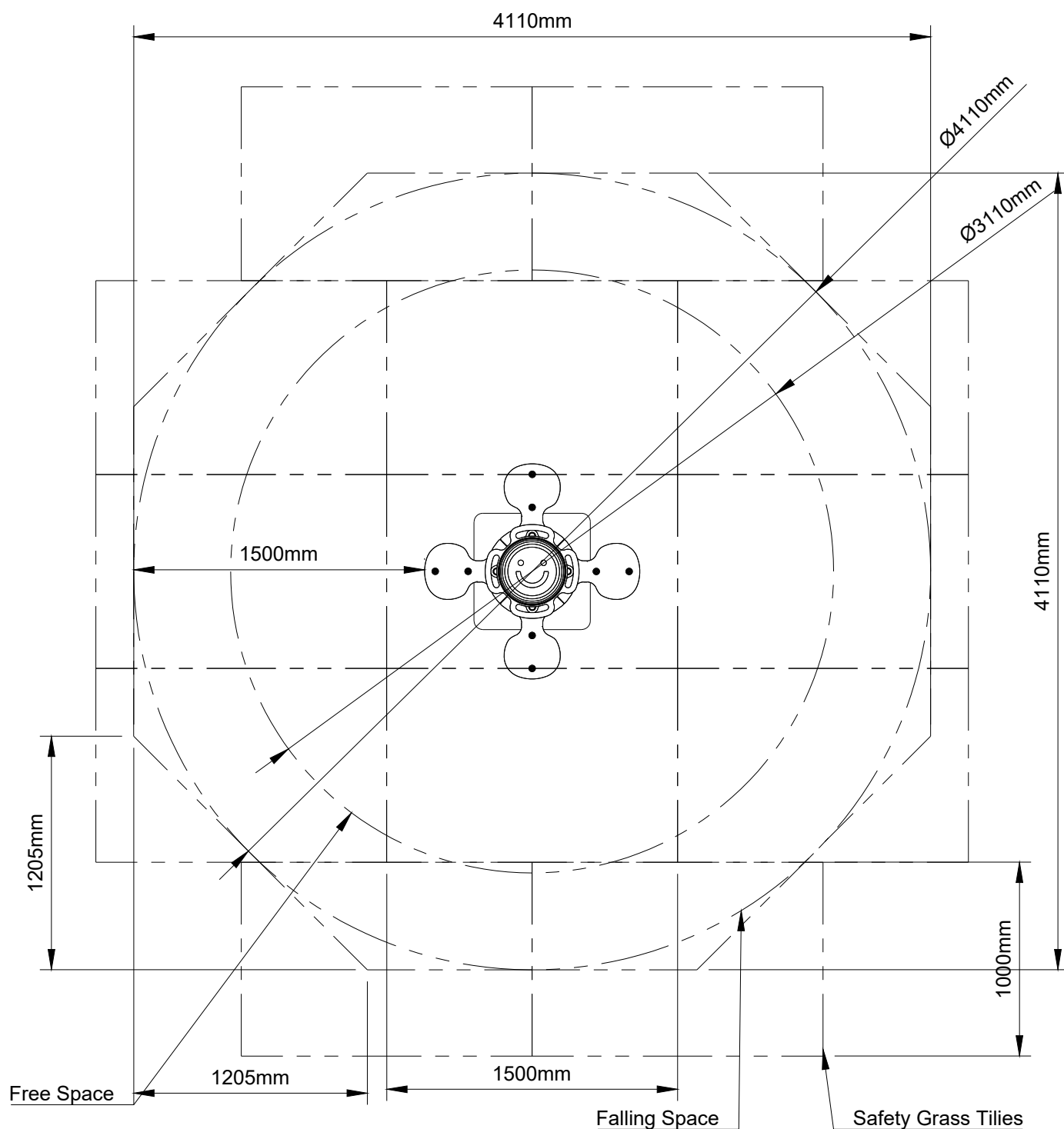

Falling Space - 13.3m²
Safety Grass Tiles - 13



Call us +44(0)131 214 1180

www.inclusiveplay.com

info@inclusiveplay.com