

Installation Sheet for IP14- Rainmaker



Product Name	Rainmaker
Product Code	IP14
Document Release Date	07/09/2021
Document Rev	1
Total Install Hours	2 Hours
Cement Required	0.10m ³

Installation Sheet for IP14- Rainmaker

INSTALLATION OVERVIEW



Two people are required for this installation.

Day One - 2 Hours

Check that all bolts and fixing are secure before installation.

Excavate to 400mm x 610mm x 450mm. See page 2. This is for the ground anchor support and cement.

Place a slab or similar hard standing base into the bottom of the excavated hole. Ensure this is level.

Position ground anchors in place. See page 3. Ensure the ground anchor is level

Pour cement into the excavated hole, making sure that the inground support structure is fully immersed.

A total of 0.10m³ is required of cement.

When cement is set, Ensure there are no sharp corners of the cement exposed. Ensure unit functions without breaking away from the installed foundations.

CHECK PRODUCT IS LEVEL AND SECURE.

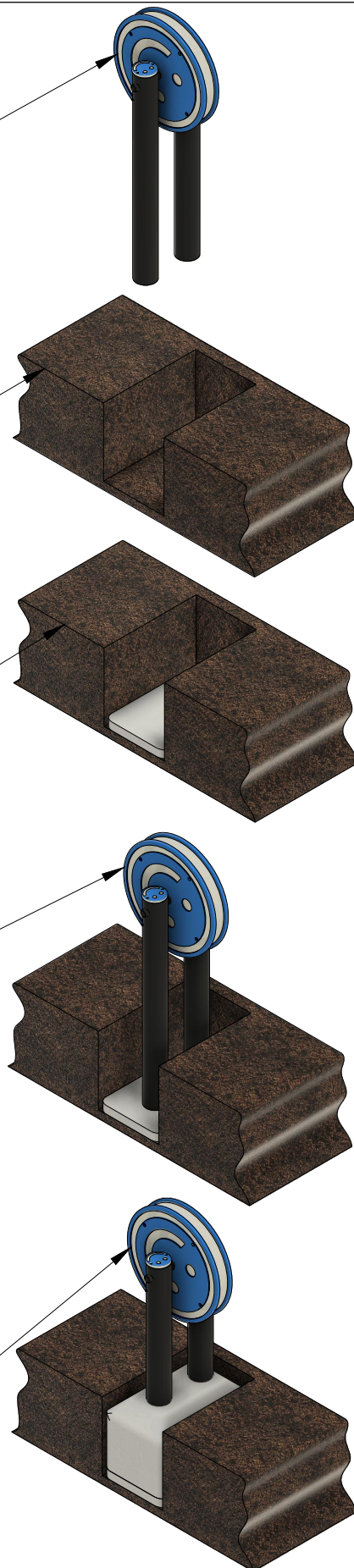

Installation Sheet for IP14- Rainmaker

Within the allocated space excavate 400mm x 610mm x 450mm.

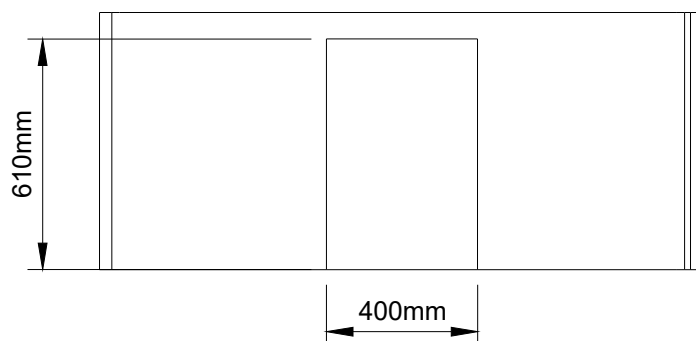
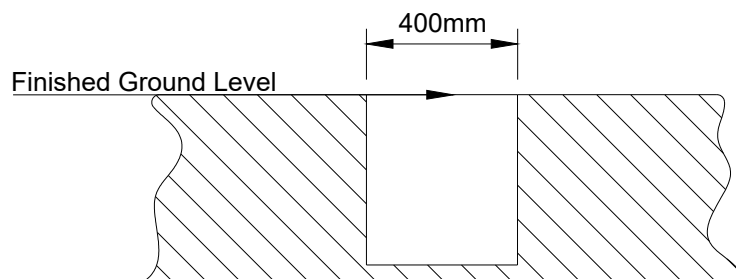

Place a slab or similar hard standing base into the bottom of the excavated hole. Ensure this is level.

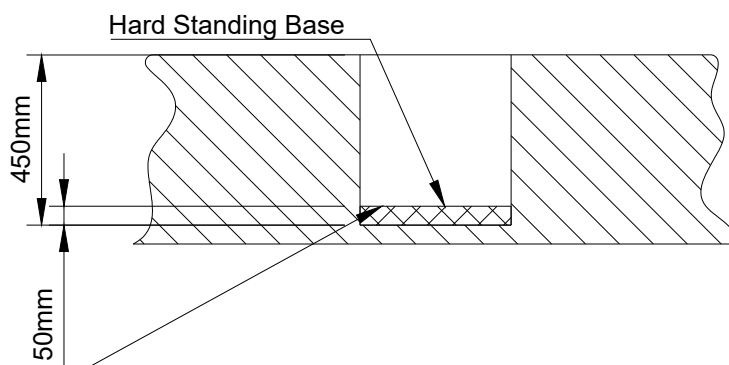

CHECK SPIRIT LEVEL



Installation Sheet for IP14- Rainmaker

Before pouring cement check the levels of the ground anchors ensuring they are straight and level.



CHECK SPIRIT LEVEL

Ensure cement corners are rounded off.

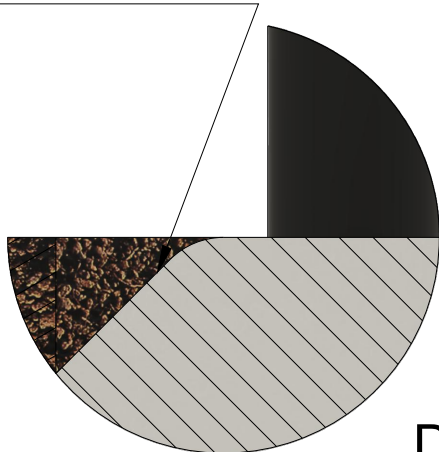

D

0.10 m³ cement volume required.

Fill to 450mm deep and check Ground Anchors are level making small adjustments where required before the cement sets.

Ensure cement corners are rounded off.

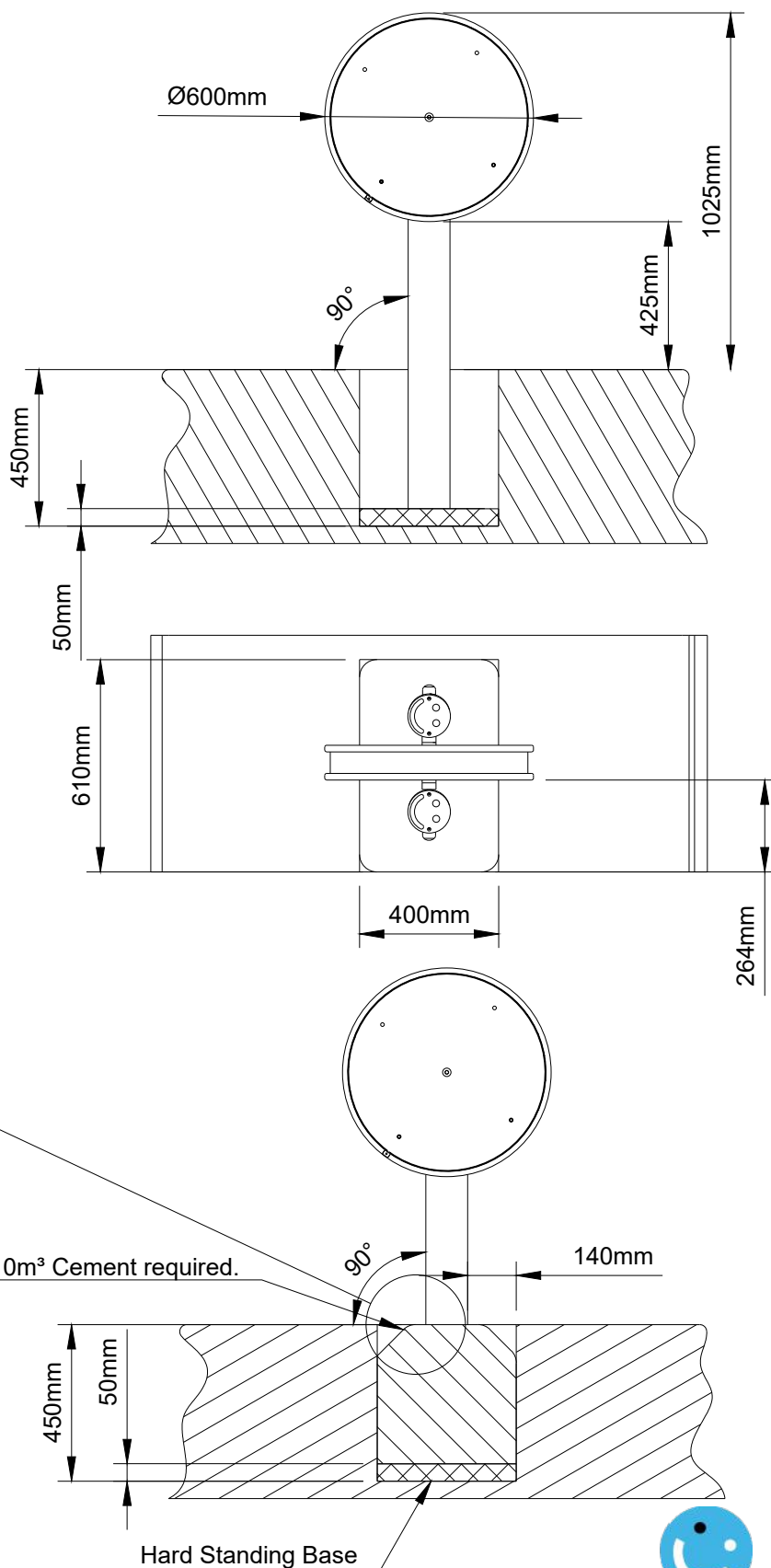

**inclusive
play**

Installation Sheet for IP814- Rainmaker

Detail View

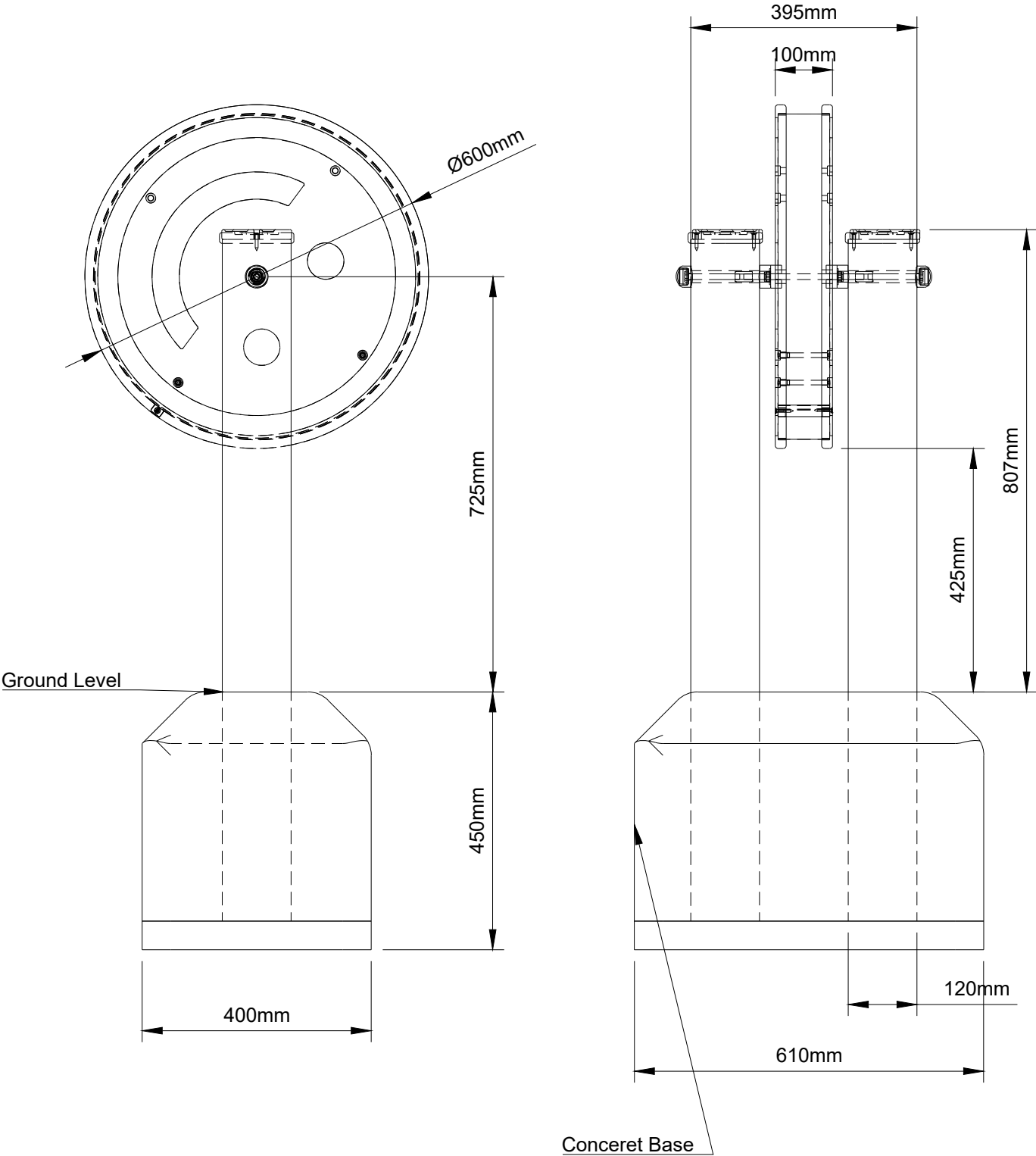

Installation Sheet for IP14- Rainmaker

Exploded Wheel Assembly

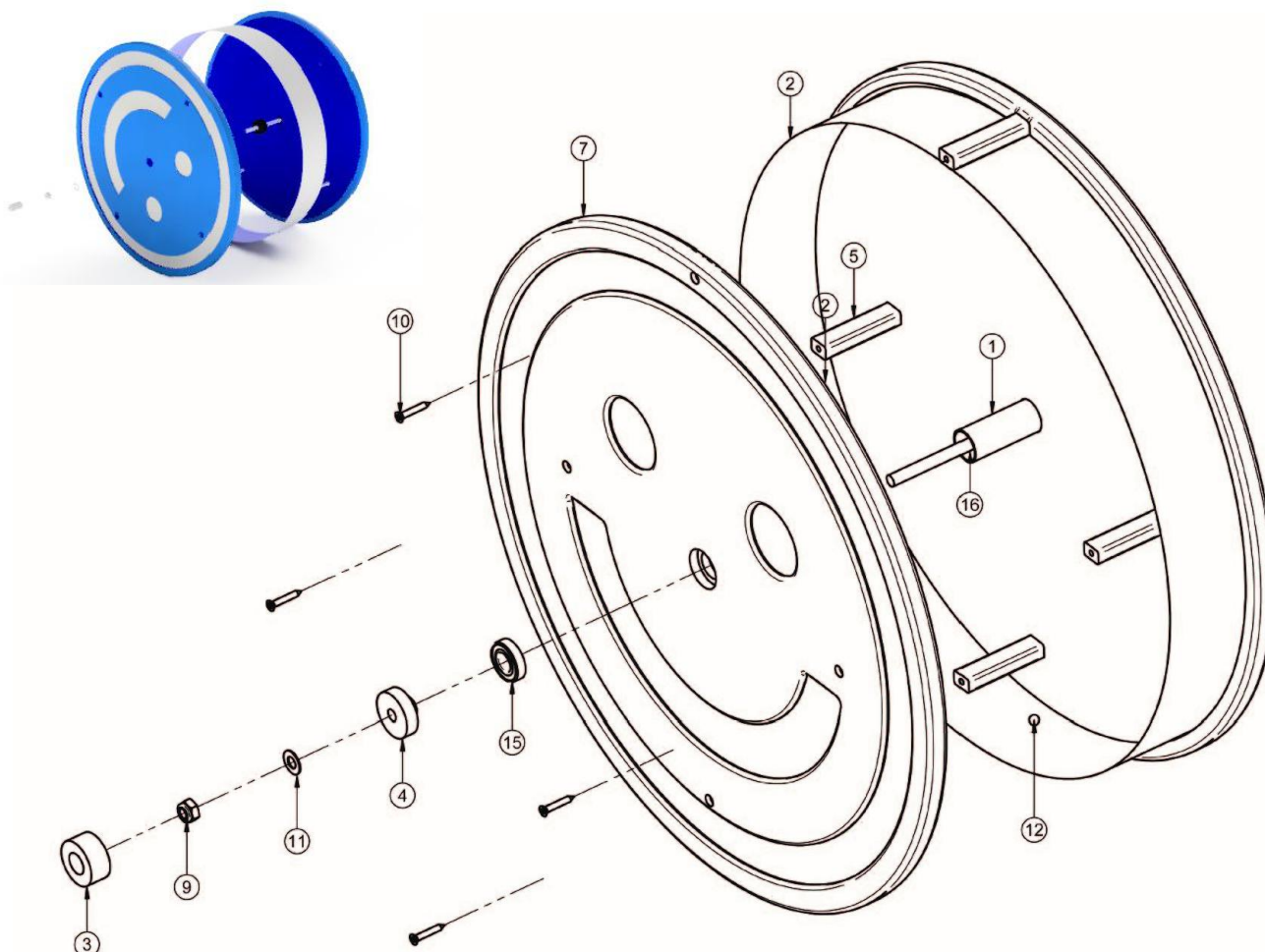

ITEM NO	PART NO	DESCRIPTION	QTY
1	FME0067 - A	SS Tube Spacer 28.4mm O/D, 25.4 I/D, 70mm	1
2	FME0083 - C	Spinning Rain Wheel- Perforated SS Mesh	1
3	FPL0312 - A	Spinning Rain Wheel - nut cover cap	2
4	FPL0313 - A	Spinning Rain Wheel - bearing Spiggot	2
5	FPL0314 - A	Spinning Rain Wheel - Inner and Outer Support	4
7	FPL0578 - B	Rainmaker Side Panel	2
9	FSU0010 - A	M10 Nyloc Nut - SS	2
10	FSU0021 - A	10G x 1, 1/4" (4.8x32mm) Torx Security Screw - SS	12
11	FSU0031 - A	M10 Washer - SS	4
12	FSU0095 - A	8mm Ball Bearing - SS	200
15	FSU0131 - A	Sealed Roller Bearing 17ID x 35OD x 10mm - SS	2
16	FSU0145 - B	M10 x 220mm Threaded Bar - ZP	1

Installation Sheet for IP14- Rainmaker

Exploded Mount Wheel to Post

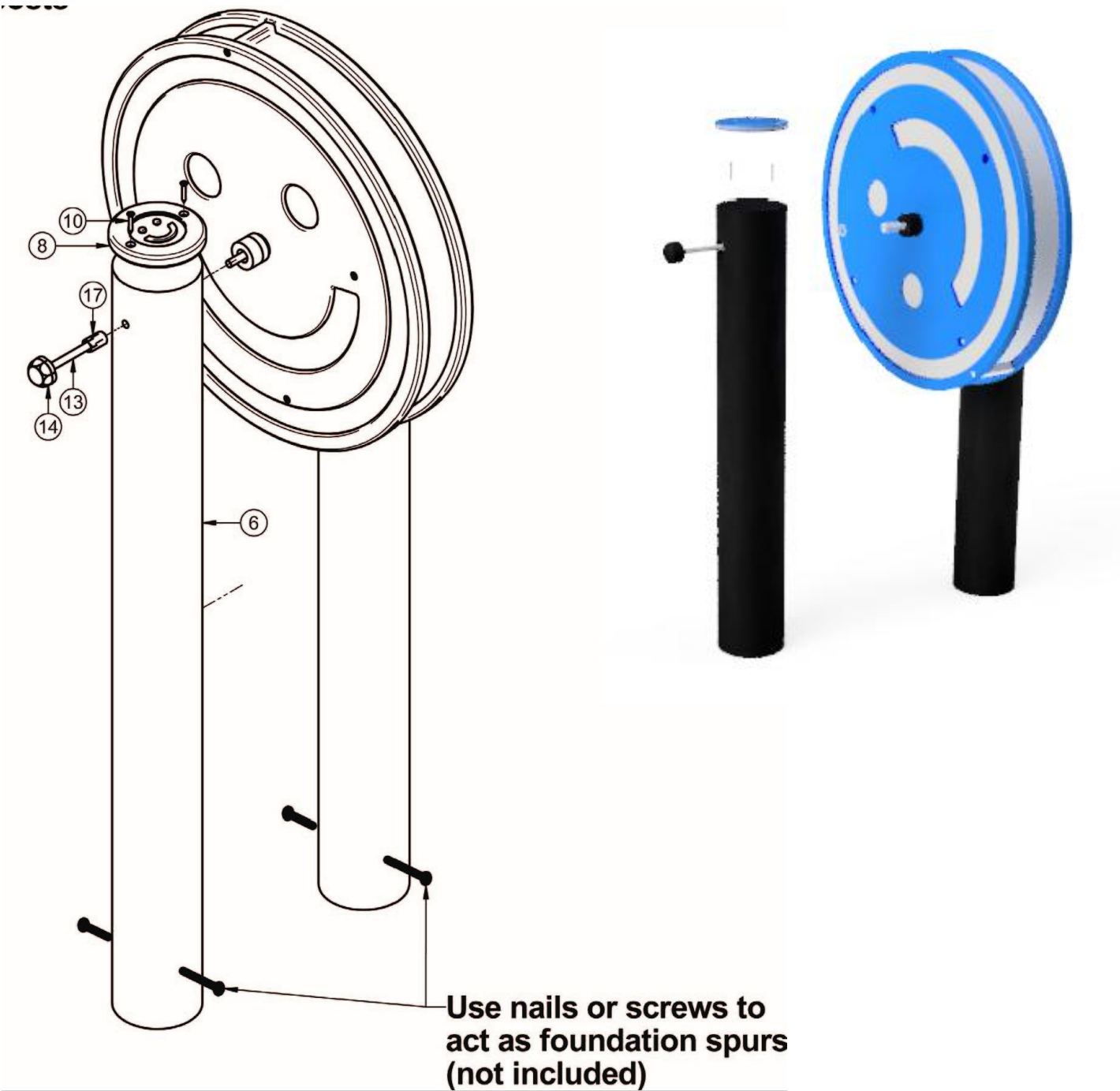

ITEM NO	PART NO	DESCRIPTION	QTY
6	FPL0375 - A	Recyled Plastic Post 120 Dia - 1200mm long	2
8	FPL0599 - A	120mm Dia Post Cap - Inclusive Play	2
13	FSU0099 - A	M10 x 100mm Hex Heade Bolt -ZP	2
14	FSU0100 - A	M10 Two Piece Security Cap - flower	2
17	FSU0208 - A	M10 x 30mm Coupling Nut - ZP	2

Installation Sheet for IP14- Rainmaker

Only when the cement is set and using the fixings provided, ensure all fixings are tight and secure before making good the surface by packing down any gaps with the surface material.

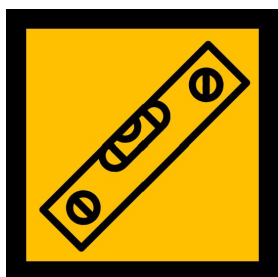

Check to ensure the installed unit is level.

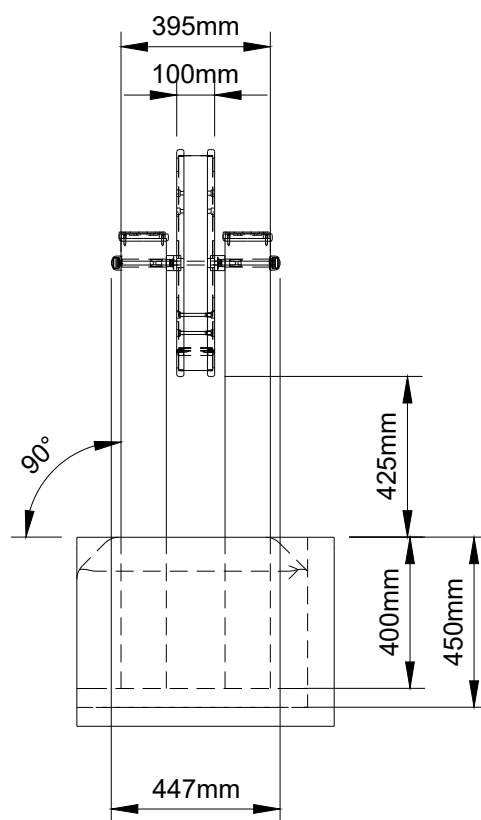

Installation Sheet for IP14- Rainmaker

Safety Surfacing Detail

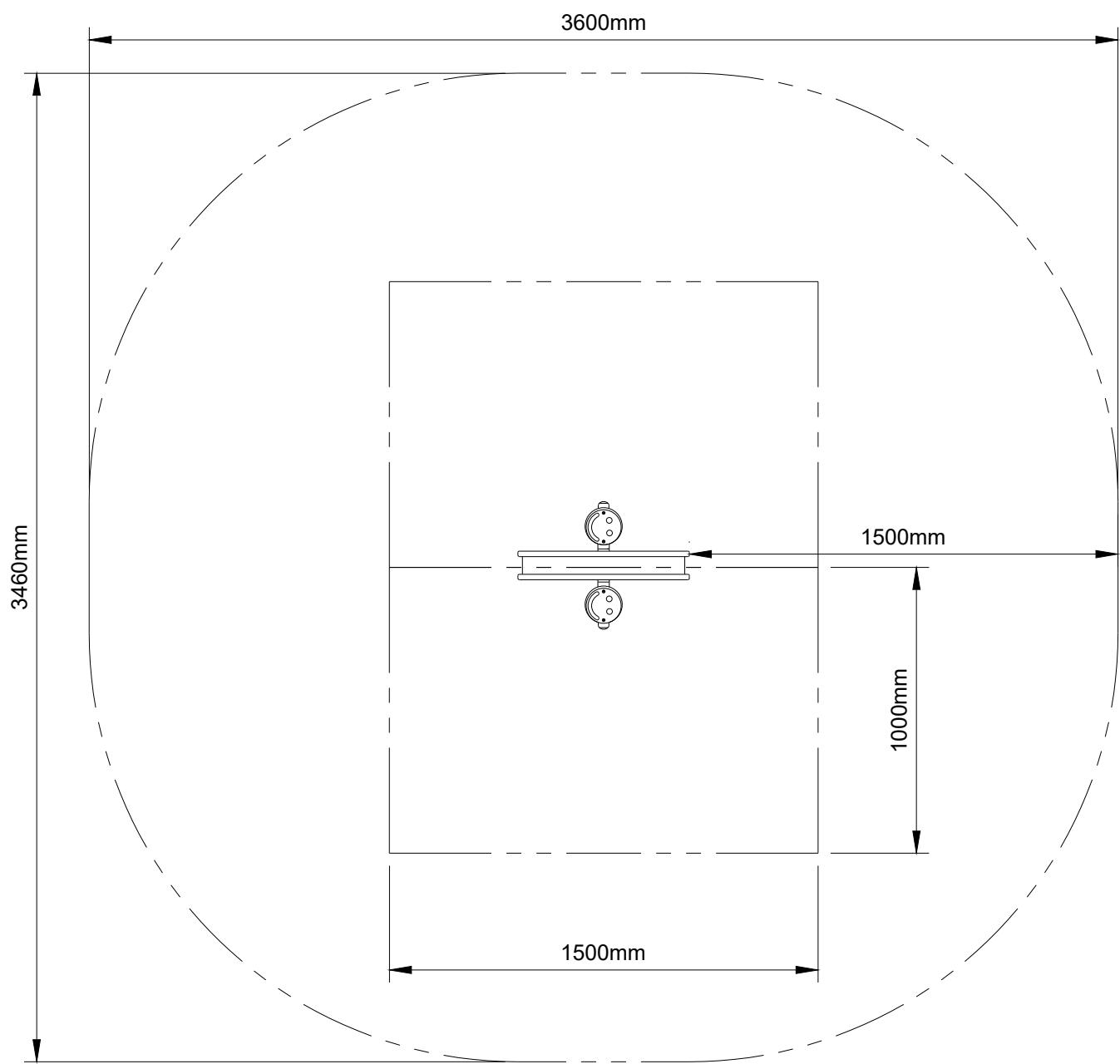

Grassmat Qty (mat - 1.5m ²)	2 mat
Loosefill (m ³)	N/A
Falling Space	N/A
Age Range	4years +
Notes	We recommend a minimum 1.5m usage area around the Rainmaker