

Product Name	Mezzo
Product Code	IP07
Document Release Date	08/09/2021
Document Rev	1
Total Install Hours	3 Hours
Cement Required	0.20m³

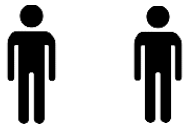

Installation Sheet for IP07 - Mezzo

INSTALLATION OVERVIEW



Two people are required for installation.

Day One - 3 Hours

Check that all bolts and fixing are secure before installation.

Excavate to 600mm x 600mm x 550mm. See page 3. This is for the ground anchor support and cement.

Place a slab or similar hard standing base into the bottom of the excavated hole. Ensure this is level.

Position ground anchors in place. See page 4. Ensure the ground anchor is level.

Pour cement into the excavated hole, making sure that the inground support structure is fully immersed, leaving only the springs exposed.

A total of 0.20m³ is required of cement.

When cement is set, Ensure there are no sharp corners of the cement exposed. Ensure unit functions without breaking away from the installed foundations.

CHECK PRODUCT IS LEVEL AND SECURE.

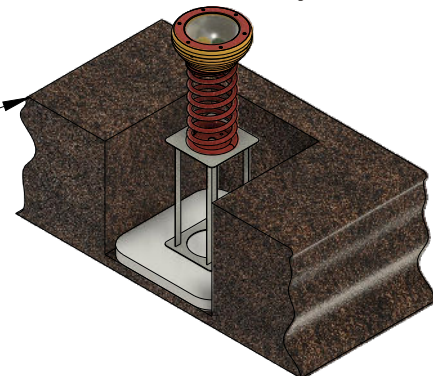
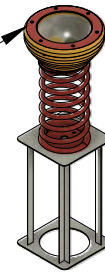

Installation Sheet for IP07 - Mezzo

Within the allocated space excavate 600mm x 600mm x 550mm.

Finished Ground Anchor

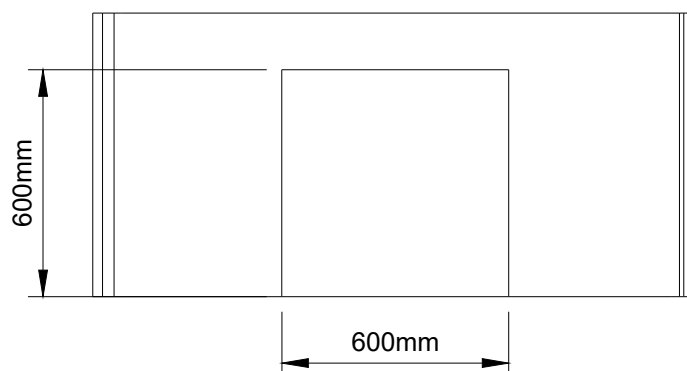
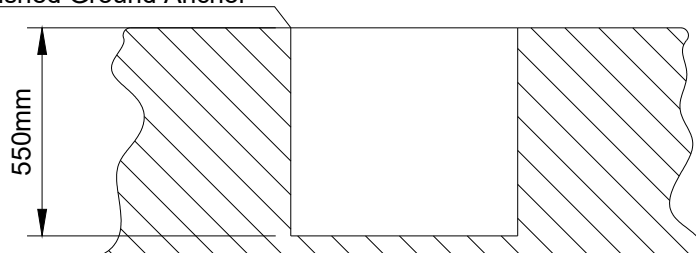

Place a slab or similar hard standing base into the bottom of the excavated hole. Ensure this is level.

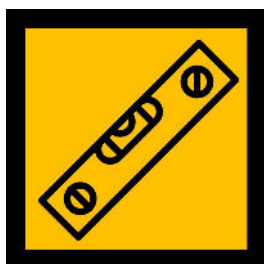

CHECK SPIRIT LEVEL

Hard Standing Base

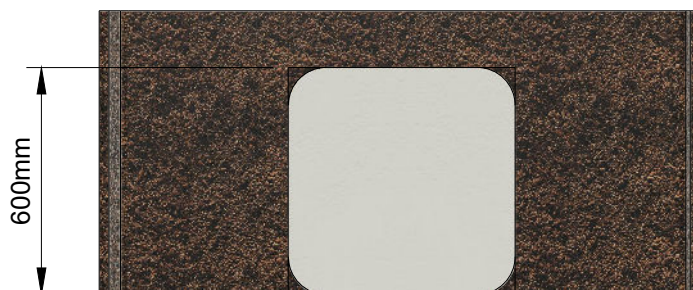
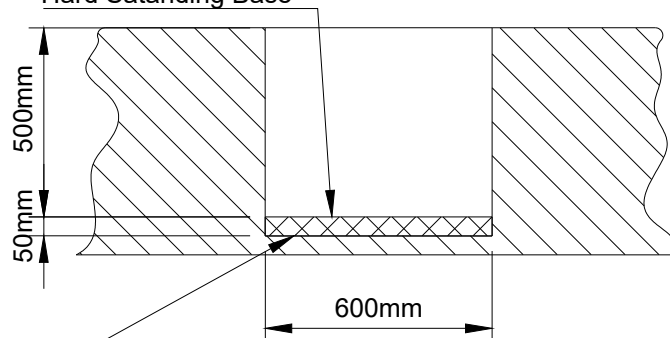

Hard Standing Base

Installation Sheet for IP07 - Mezzo

Before pouring cement check the levels of the ground anchors ensuring they are straight and level.

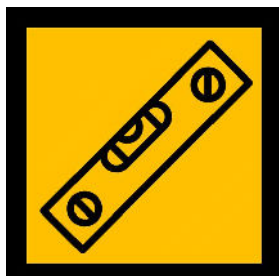

CHECK SPIRIT LEVEL

Ensure cement corners are rounded off.

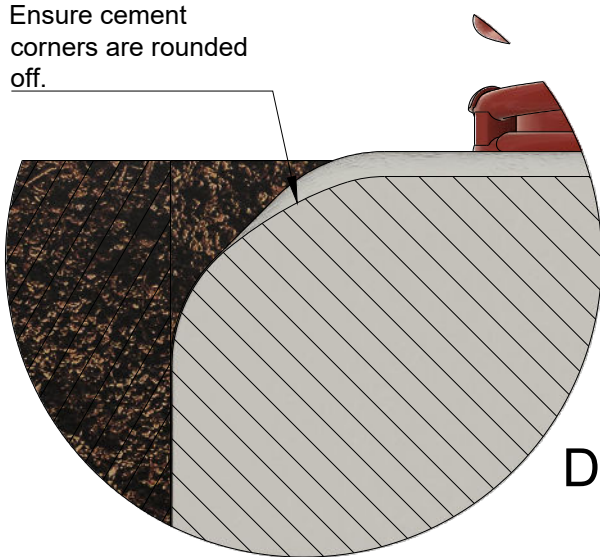

D

0.20 m³ cement volume required.

Fill to 500mm deep and check Ground Anchors and Springs are level making small adjustments where required before the cement sets.

Ensure cement corners are rounded off to a 100mm radius minimum.

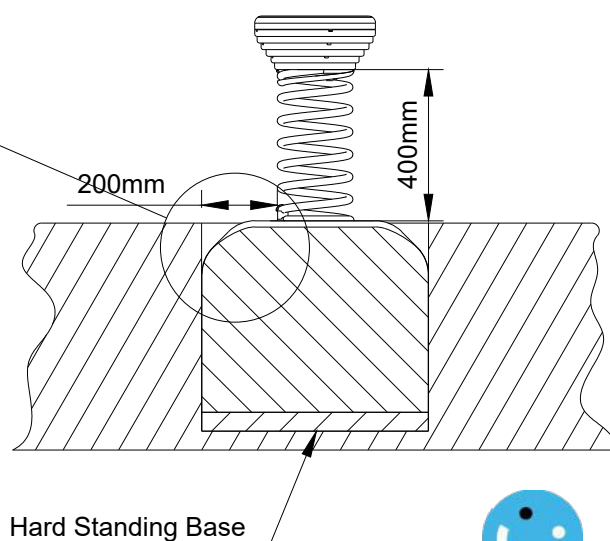
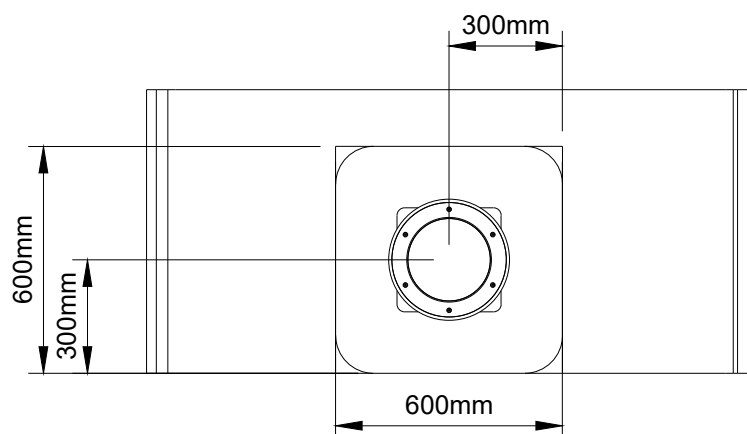
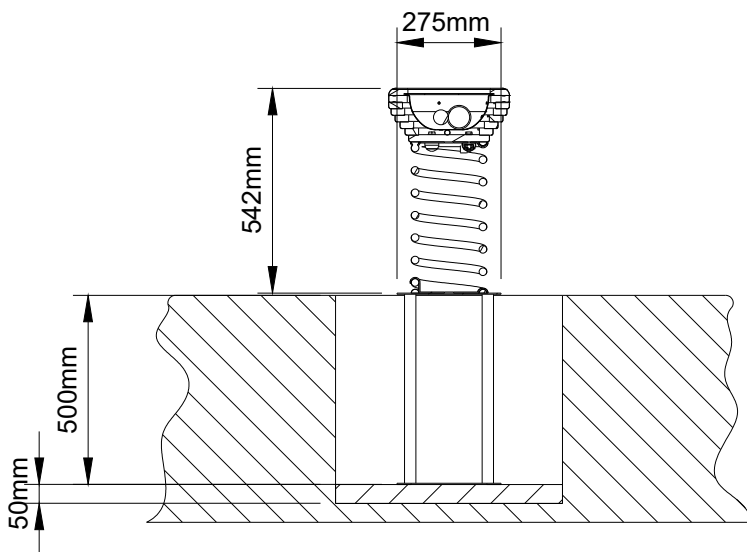

Installation Sheet for IP07 - Mezzo

Only when the cement is set, Ensure all fixings are tight and secure before making good the surface by packing down any gaps with the surface material.



Check to ensure the installed unit is level.

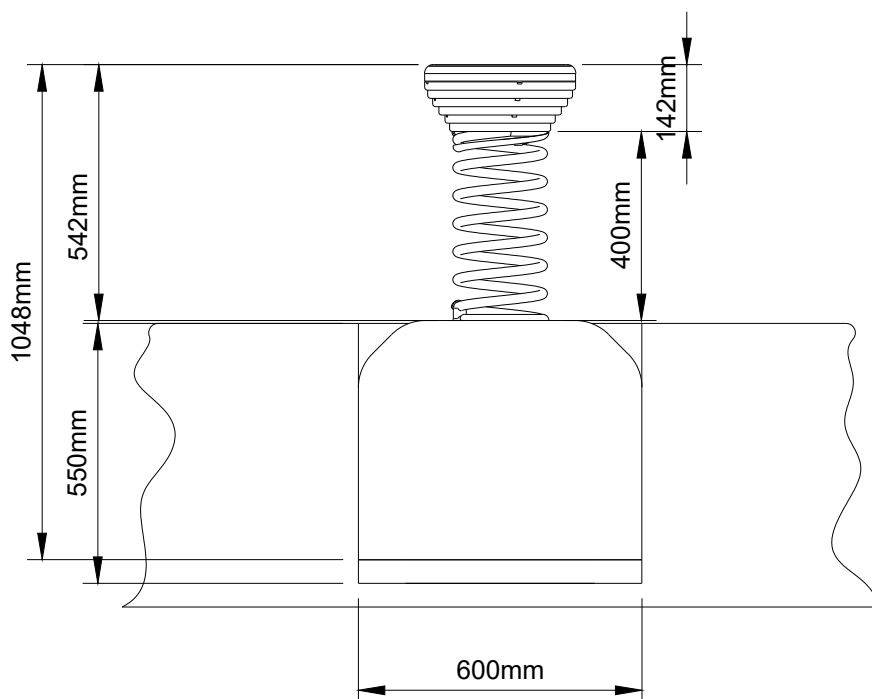

Installation Sheet for IP07 - Mezzo

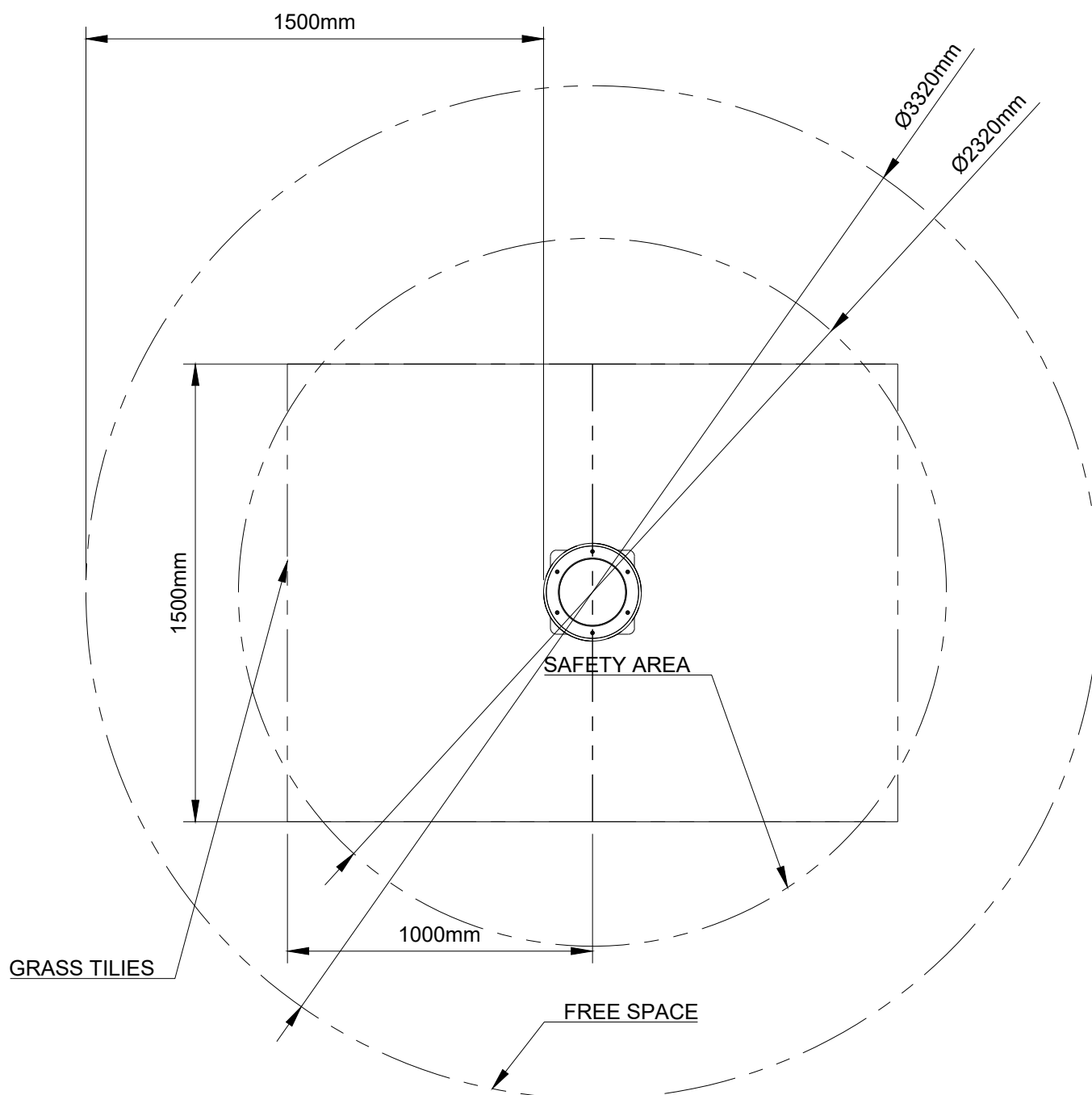

PRODUCT	IP07 Mezzo
Free Height of Fall	600mm
Wet Pour (m²)	None Required
Grassmat (mat - 1.5 m²)	2 mats for wear pad
Loosefil (m²)	None Required