

Installation Sheet for IP05 - Orb



Blue and White



Blue and Yellow

Product Name	Orb
Product Code	IP05
Document Release Date	14/06/2021
Document Rev	1
Total Install Hours	3 Hours
Cement Required	0.14m ³



Green and Beige



Green and Yellow



Call us +44(0)131 214 1180

www.inclusiveplay.com

info@inclusiveplay.com

Installation Sheet for IP05 - Orb

INSTALLATION OVERVIEW



Two people are required for this installation.

Day One - 3 Hours

Check that all bolts and fixing are secure before installation.

Excavate to 500mm x 500mm x 550mm. See page 3. This is for the ground anchor support and cement.

Place a slab or similar hard standing base into the bottom of the excavated hole. Ensure this is level.

Position ground anchors in place. See page 4. Ensure the ground anchor is level

Pour cement into the excavated hole, making sure that the inground support structure is fully immersed, leaving only the springs exposed.

A total of 0.14m³ is required of cement.

When cement is set, Ensure there are no sharp corners of the cement exposed. Ensure unit functions without breaking away from the installed foundations.

CHECK PRODUCT IS LEVEL AND SECURE.

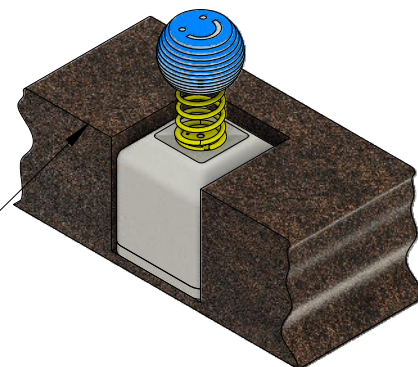
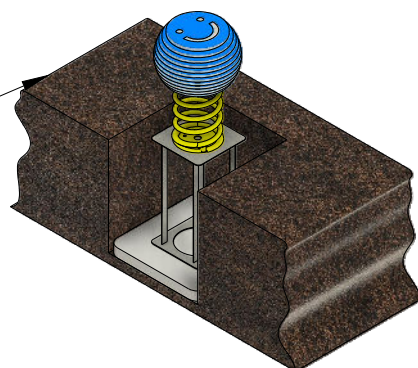
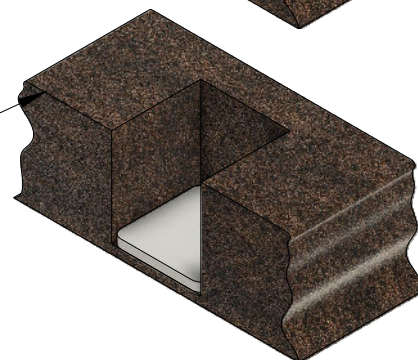
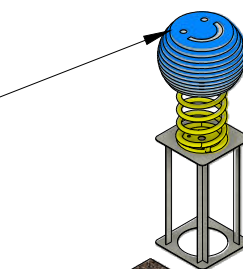

Installation Sheet for IP05 - Orb

Within the allocated space excavate 500mm x 500mm x 550mm.

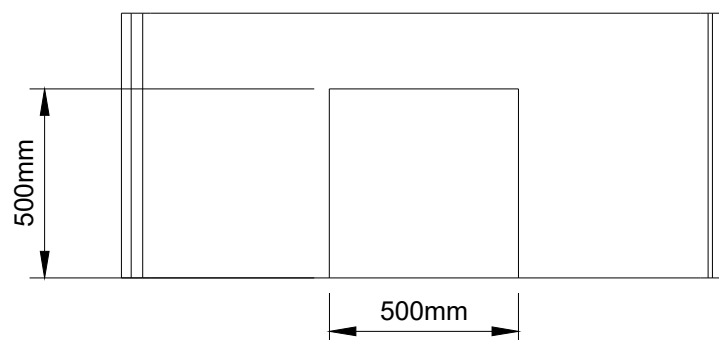
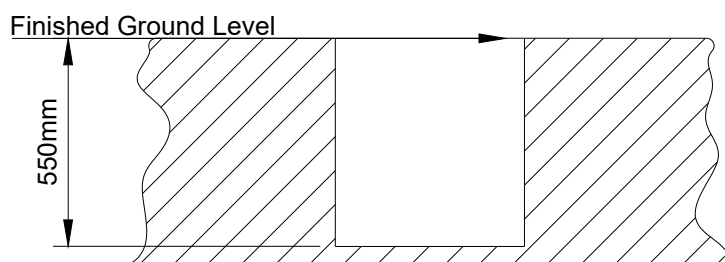

Place a slab or similar hard standing base into the bottom of the excavated hole. Ensure this is level.



CHECK SPIRIT LEVEL

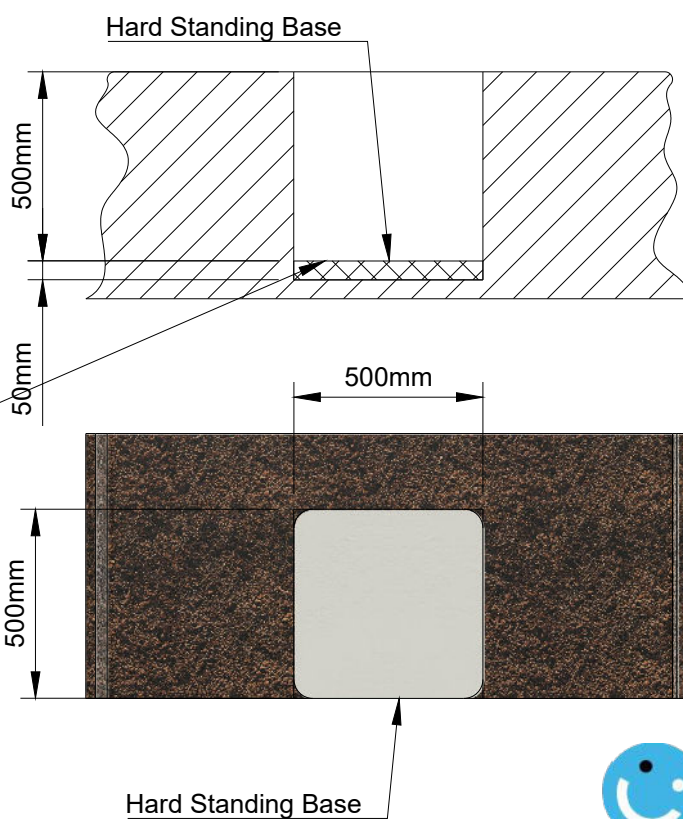

Installation Sheet for IP05 - Orb

Before pouring cement check the levels of the ground anchors ensuring they are straight and level.

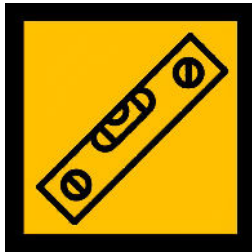

CHECK SPIRIT LEVEL

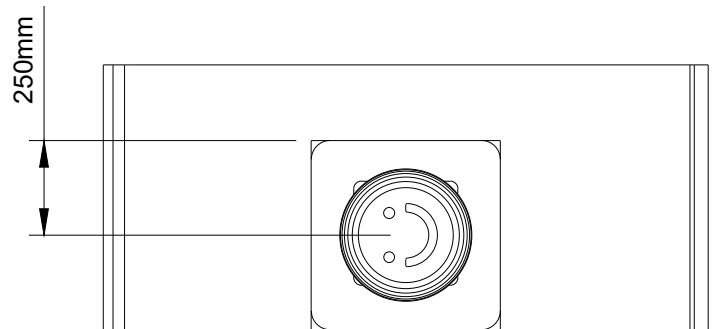
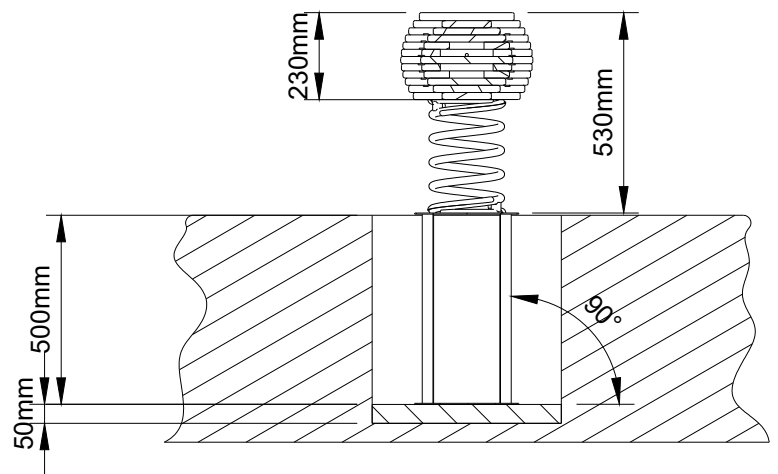

Ensure cement corners are rounded off.

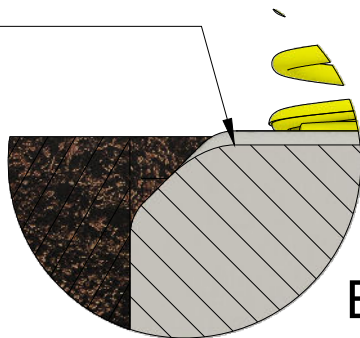

E

0.14 m³ cement volume required.

Fill to 550mm deep and check Ground Anchors and Springs are level making small adjustments where required before the cement sets.

Ensure cement corners are rounded off.

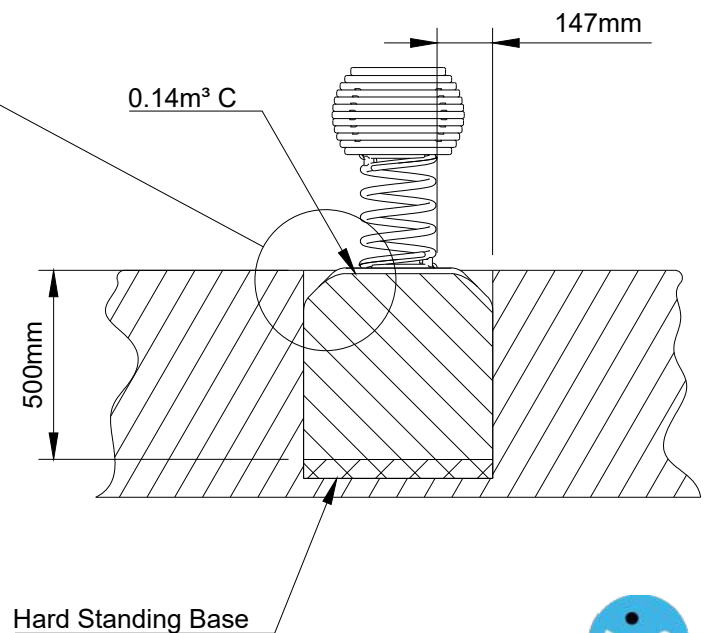

Installation Sheet for IP805 - Orb

Only when the cement is set and using the fixings provided.

Ensure all fixings are tight and secure before making good the surface by packing down any gaps with the surface material.

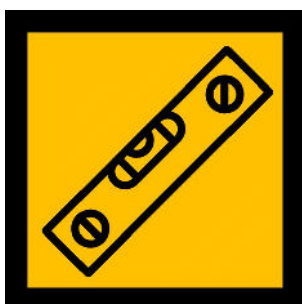

Check to ensure the installed unit is level.

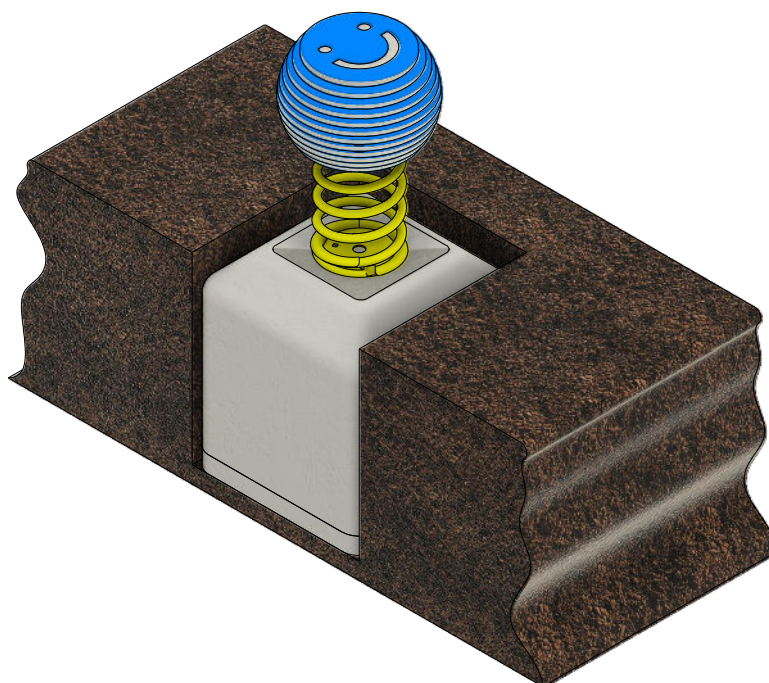
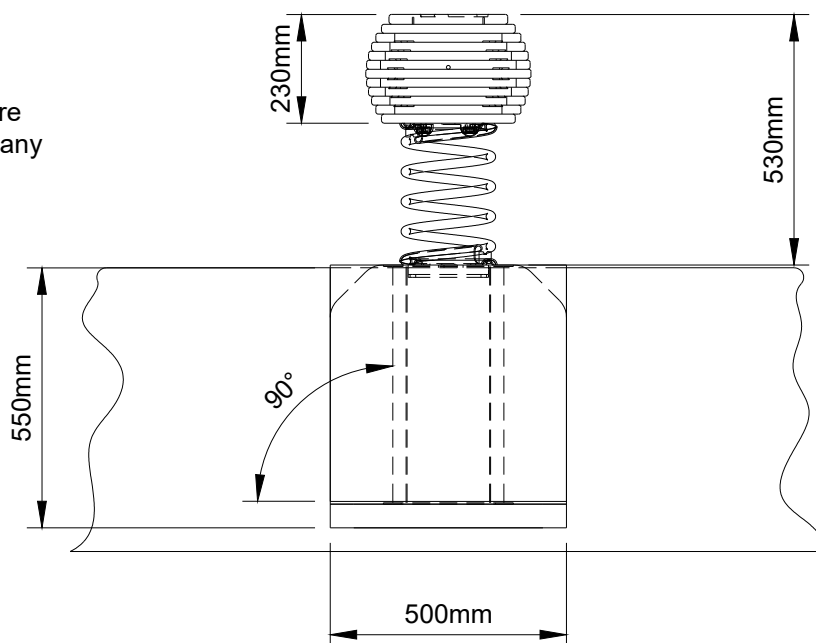

SURFACING DETAILS

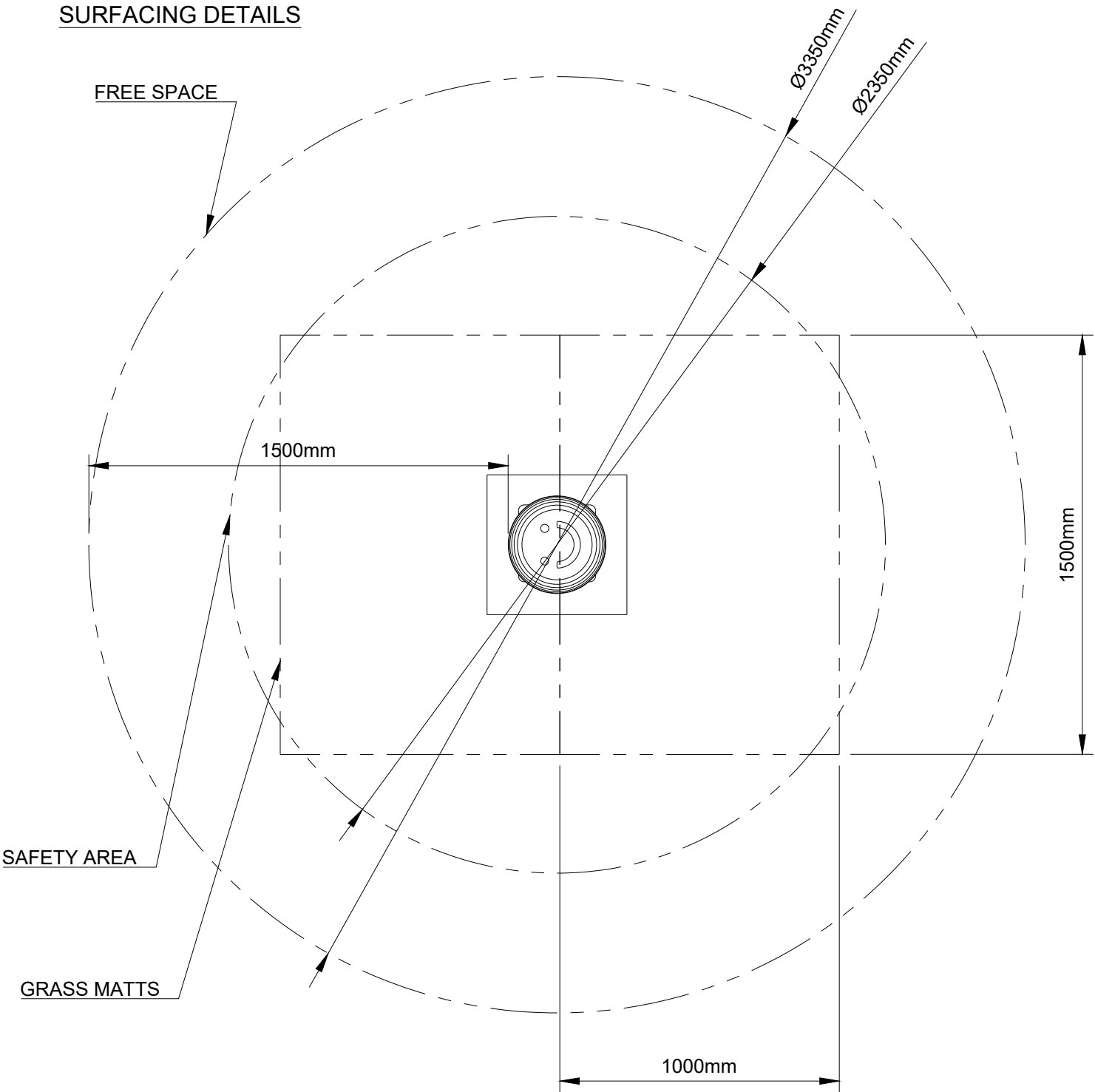

PRODUCT	IP8005 ORB
Free Fall Height	600mm
Wet Pour	4.3m²
Grass Mats	2
Loosefill	N/A